

Respecting the Past, Safeguarding the Present, and Assuring a Vital Future

-- with better zoning.



The Charge





City of Fitchburg Comprehensive Plan



Prepared By Fitchburg Planning Department - Adopted March 24, 2009;
Amended June 9 & September 22, 2009

Prepared By Fitchburg Planning Department - Adopted March 24, 2009;
Amended June 9 & September 22, 2009



The Approach





The Results



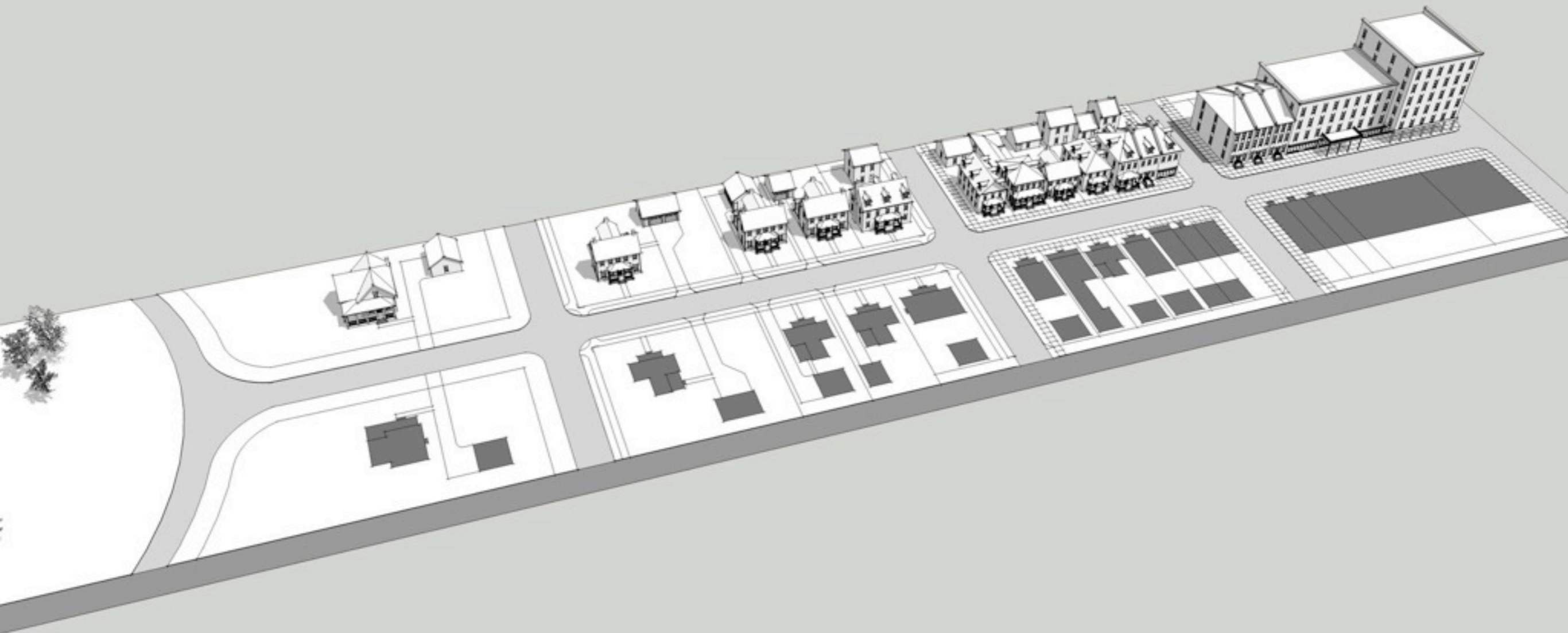

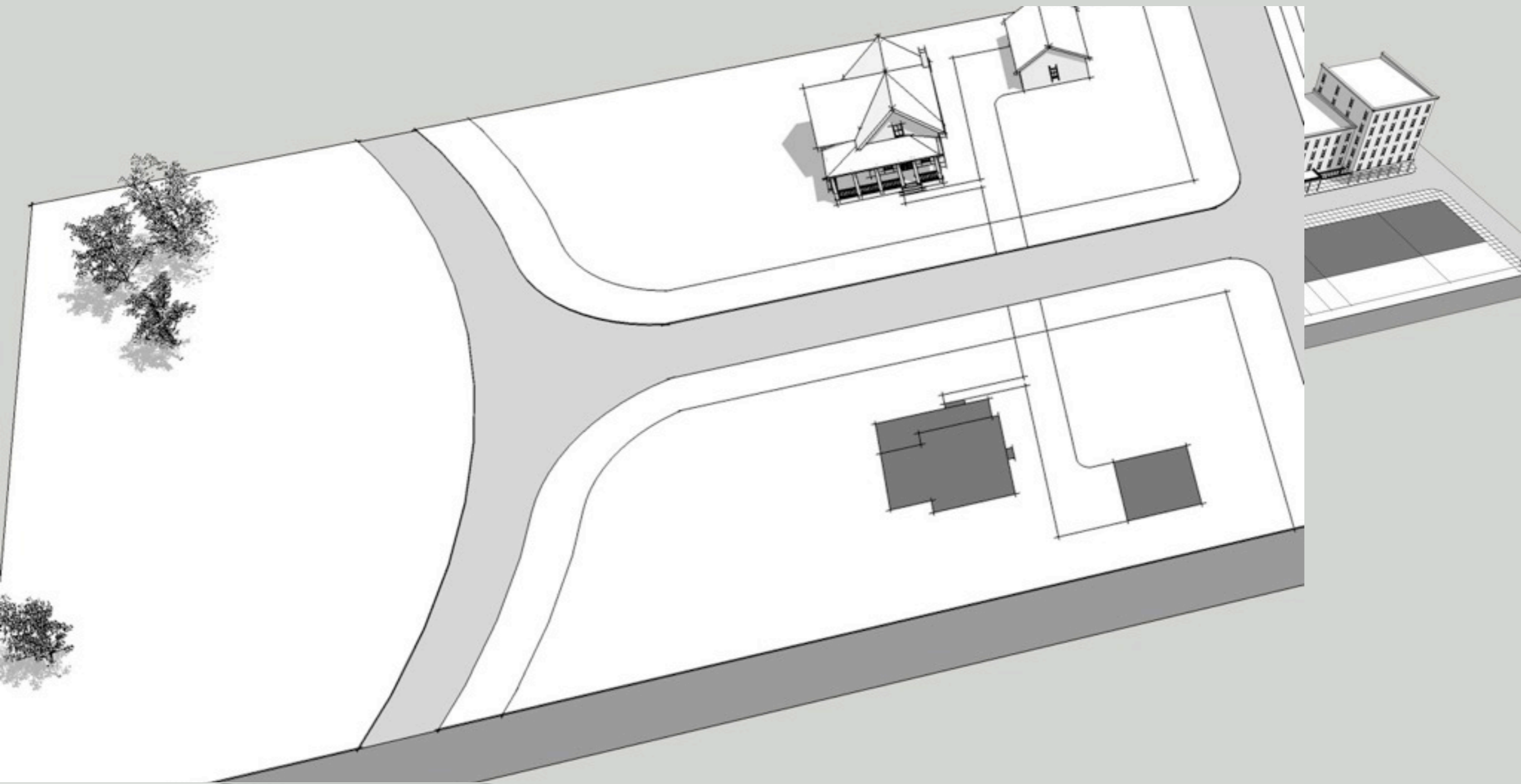



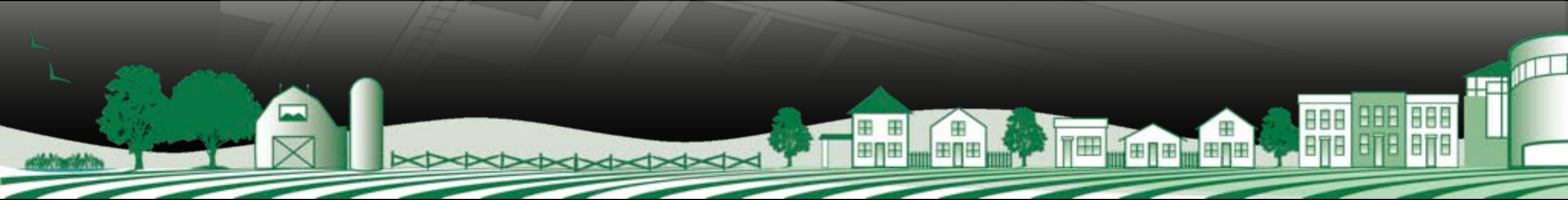
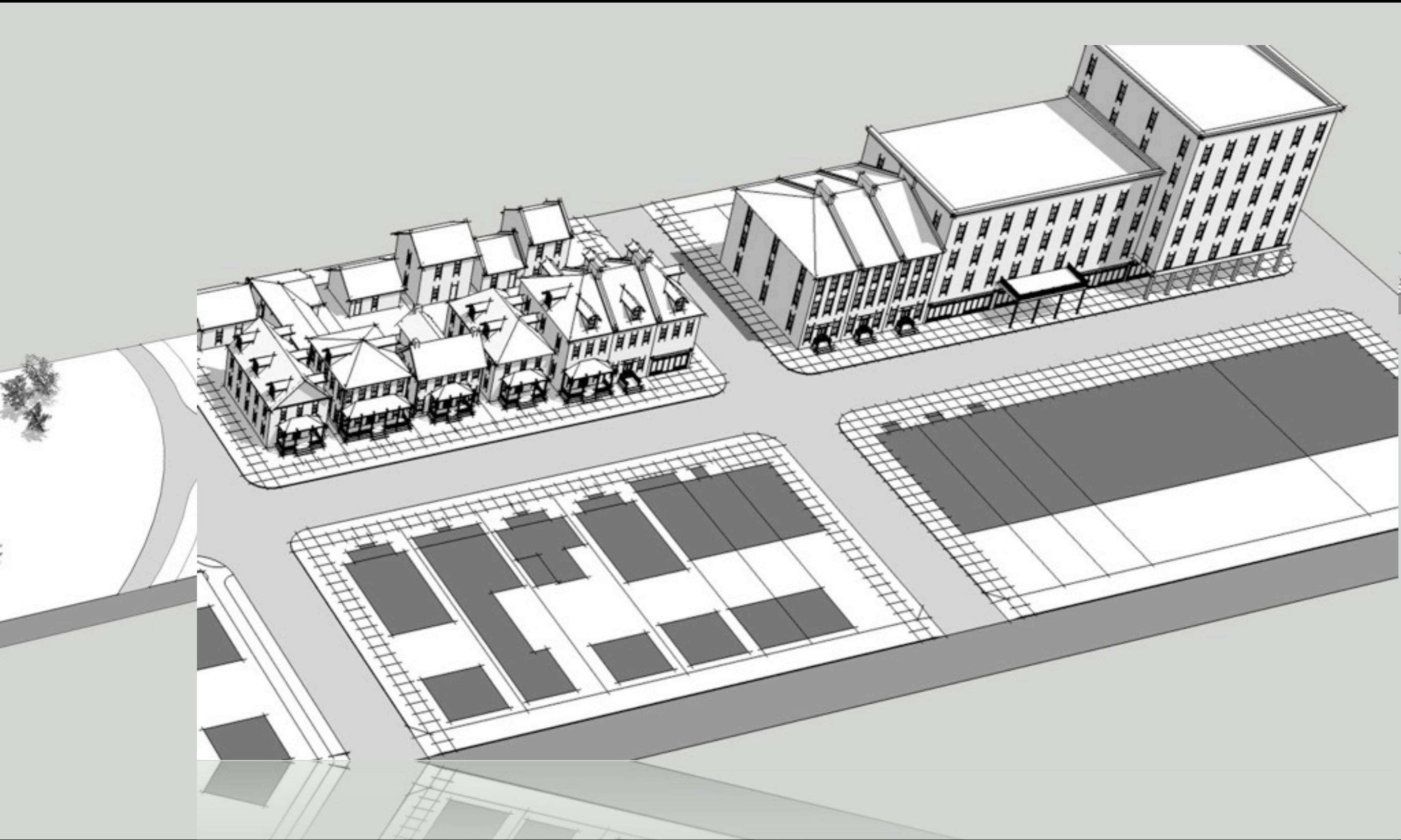

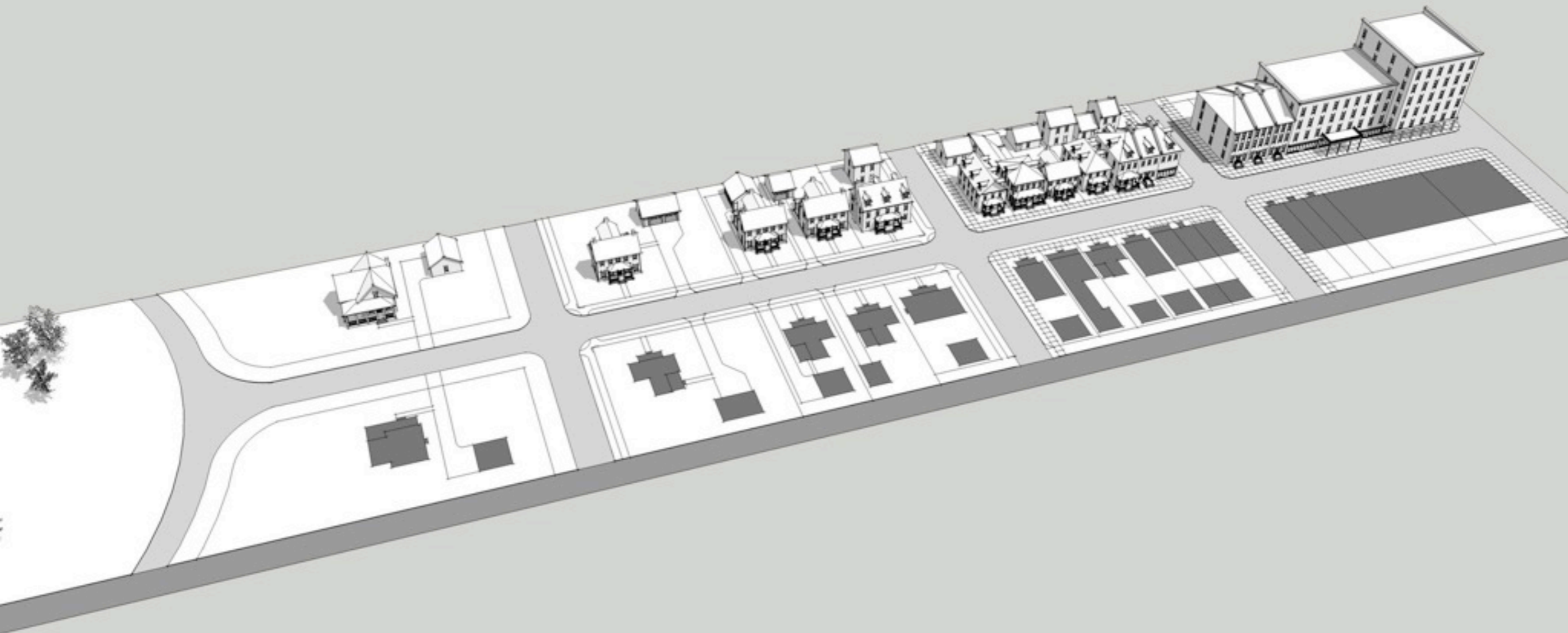





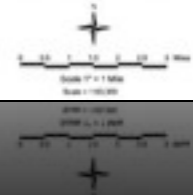
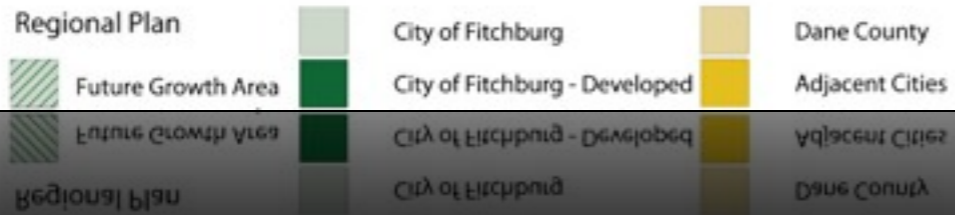
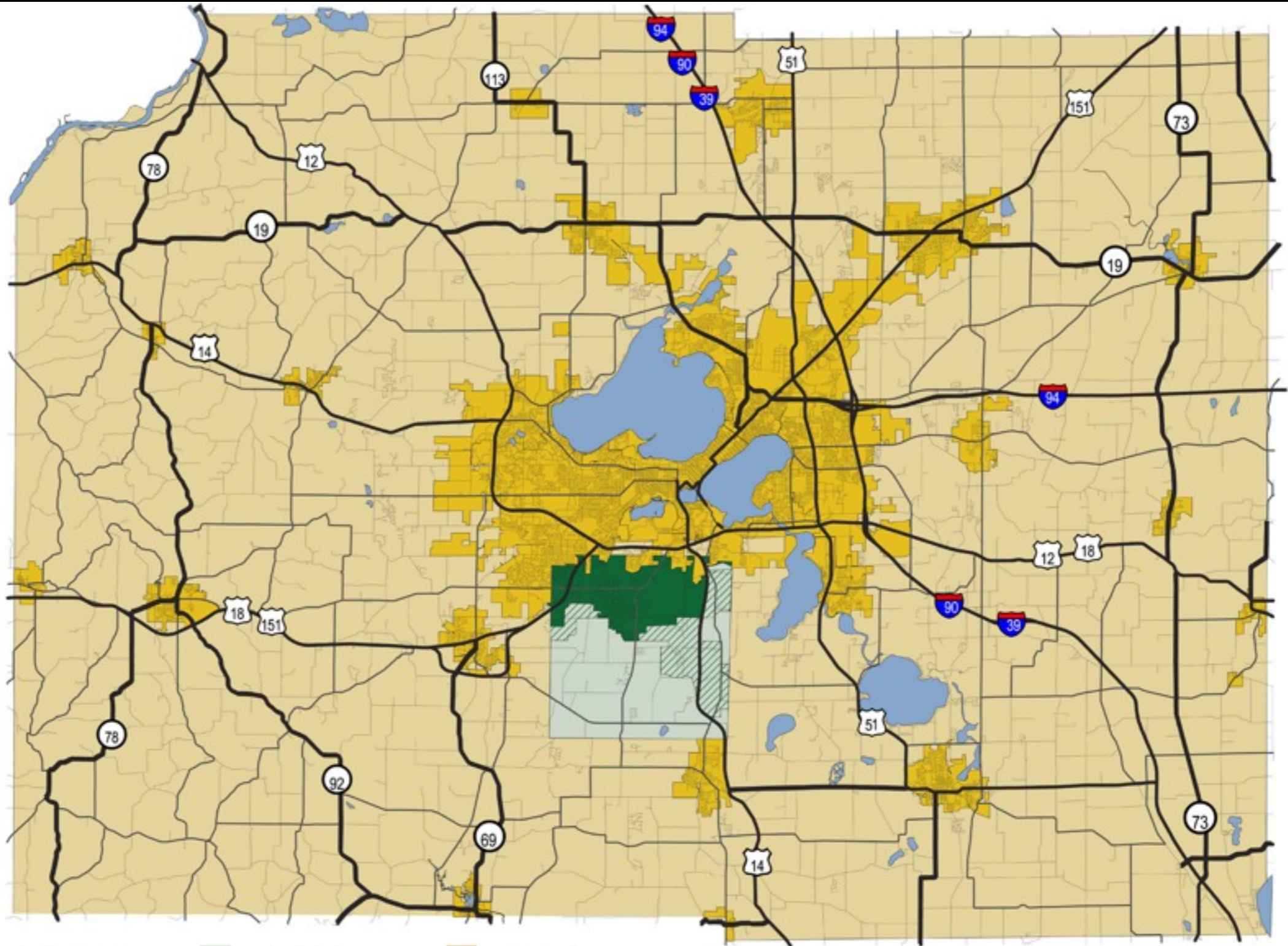

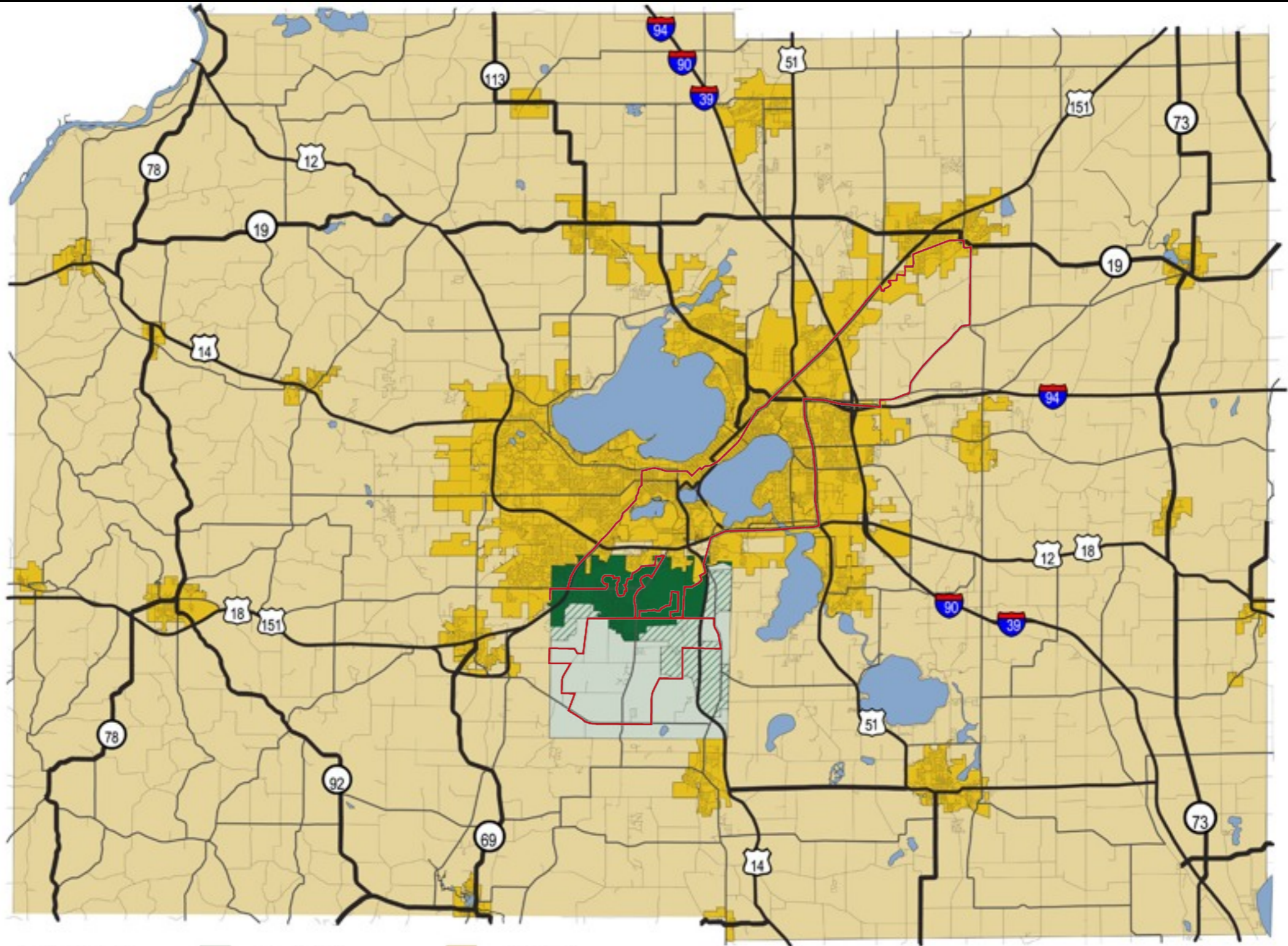



The Details

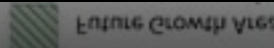

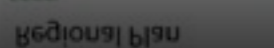



- | | | |
|--|---|---|
|  Regional Plan |  City of Fitchburg |  Dane County |
|  Future Growth Area |  City of Fitchburg - Developed |  Adjacent Cities |
|  Regional Plan |  City of Fitchburg - Developed |  Adjacent Cities |
| |  City of Fitchburg |  Dane County |

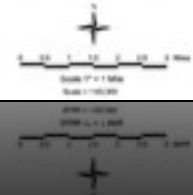

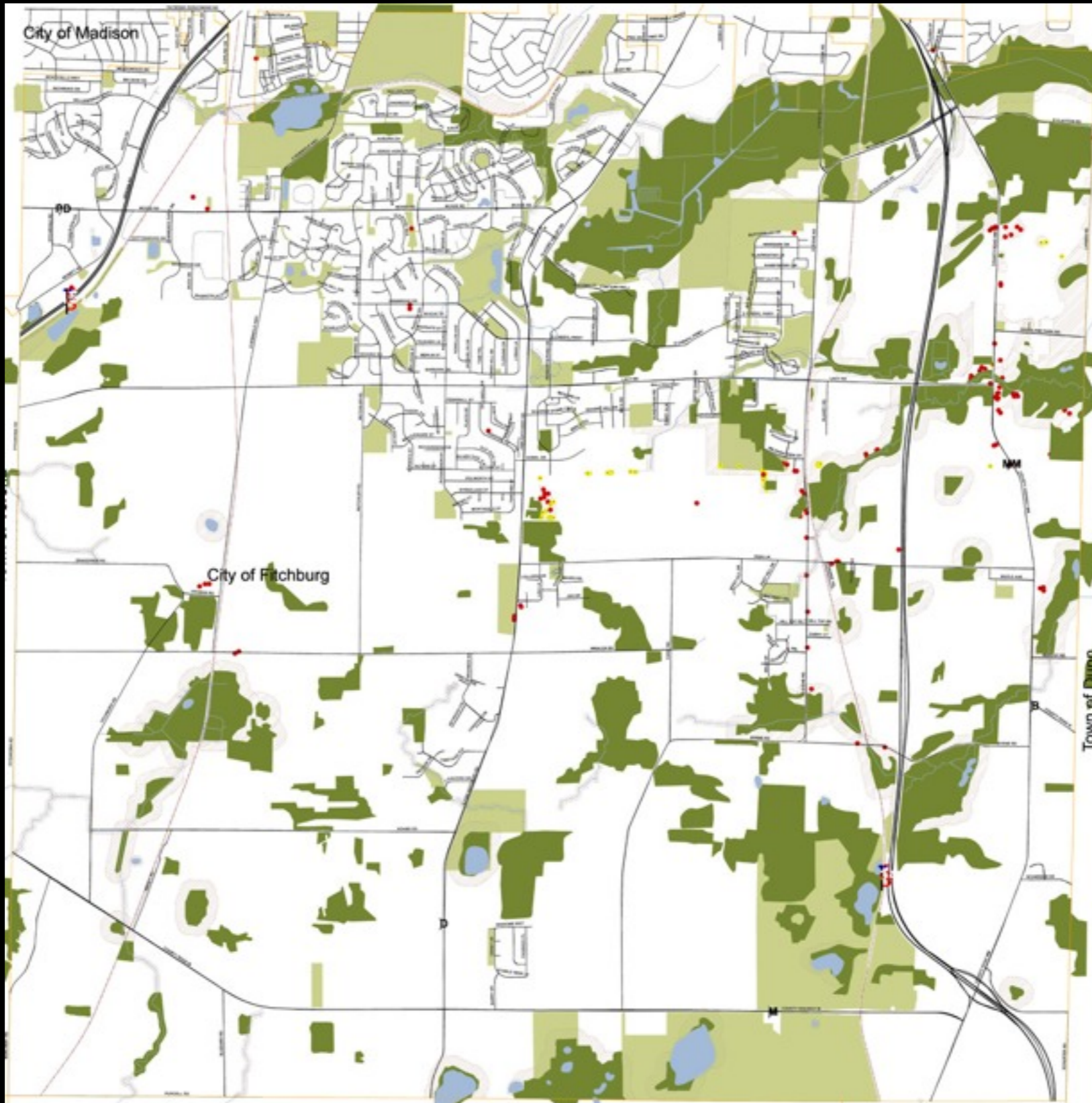



Slope Analysis

0 - 4% Slope

0 - 4% Slope

Slope Analysis

4 - 8% Slope

8 - 12% Slope

8 - 12% Slope

4 - 8% Slope

12 - 15% Slope

> 15% Slope

> 12% Slope

15 - 12% Slope





Image from FitchburgFields.org





T4 T5 T6

SD

T3

T1

T2

Image from FitchburgFields.org





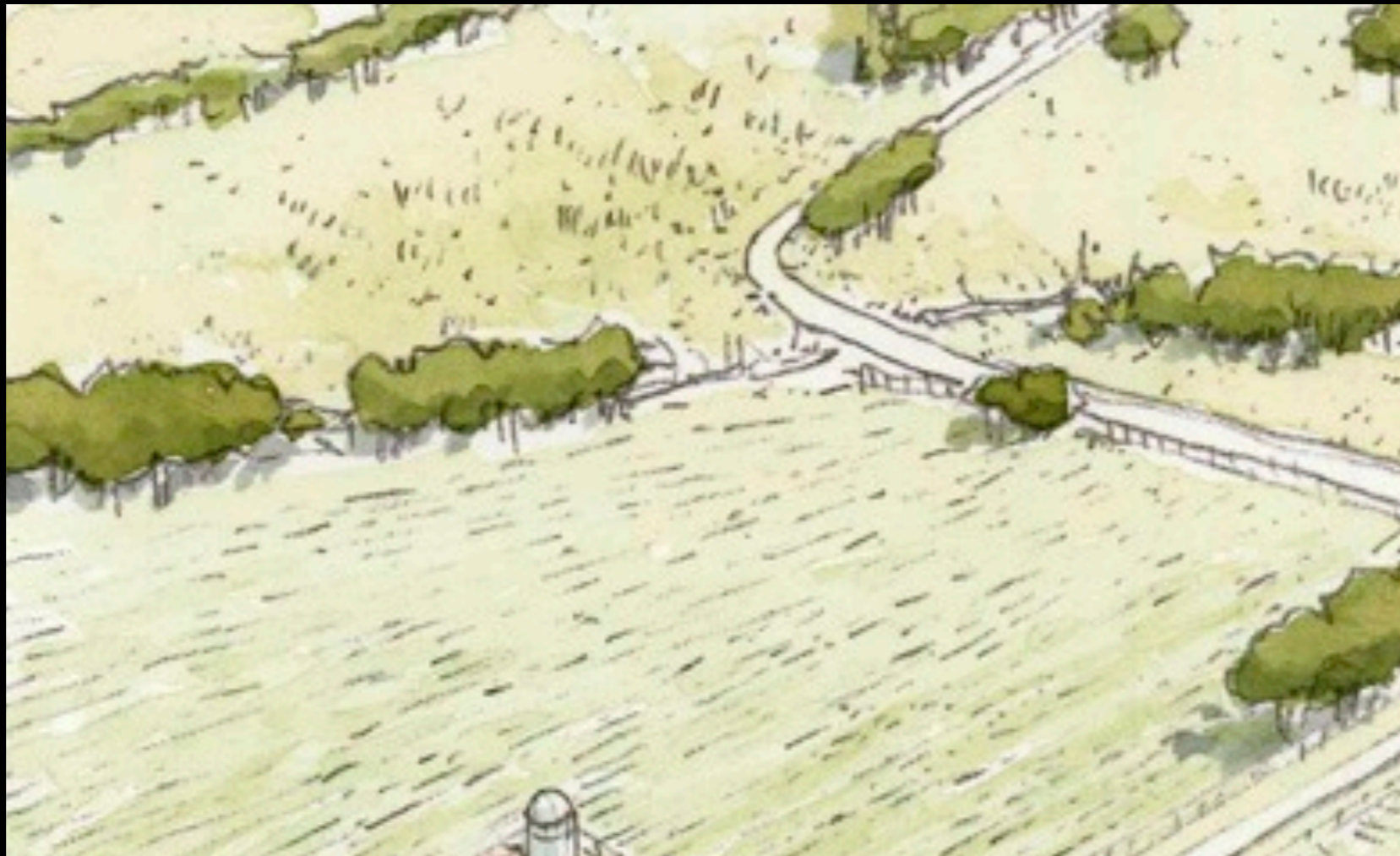

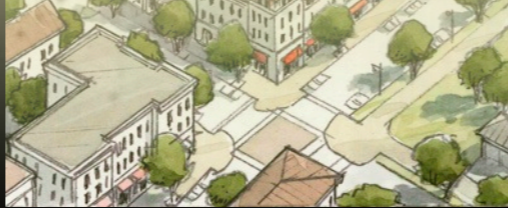
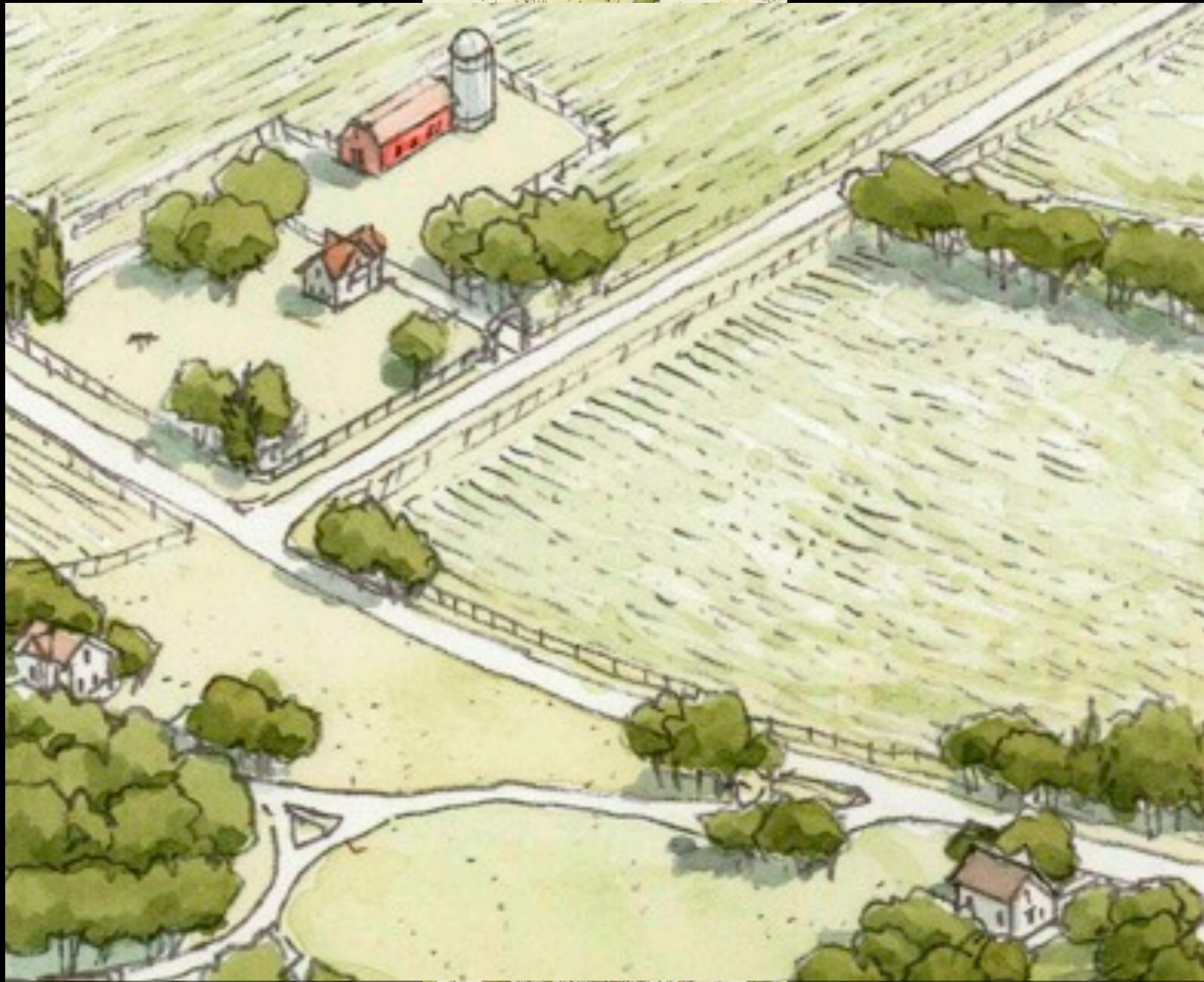
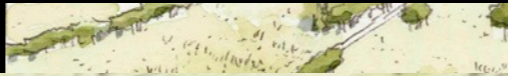

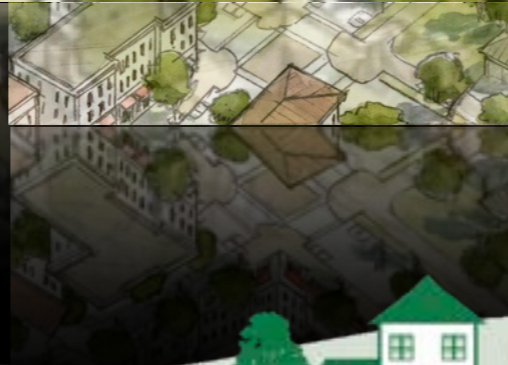

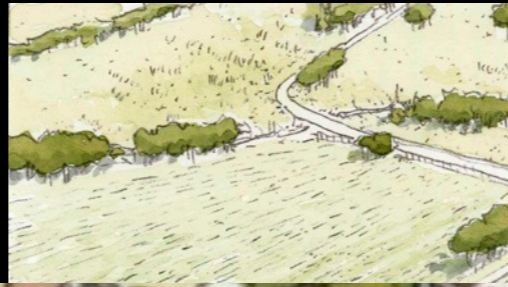

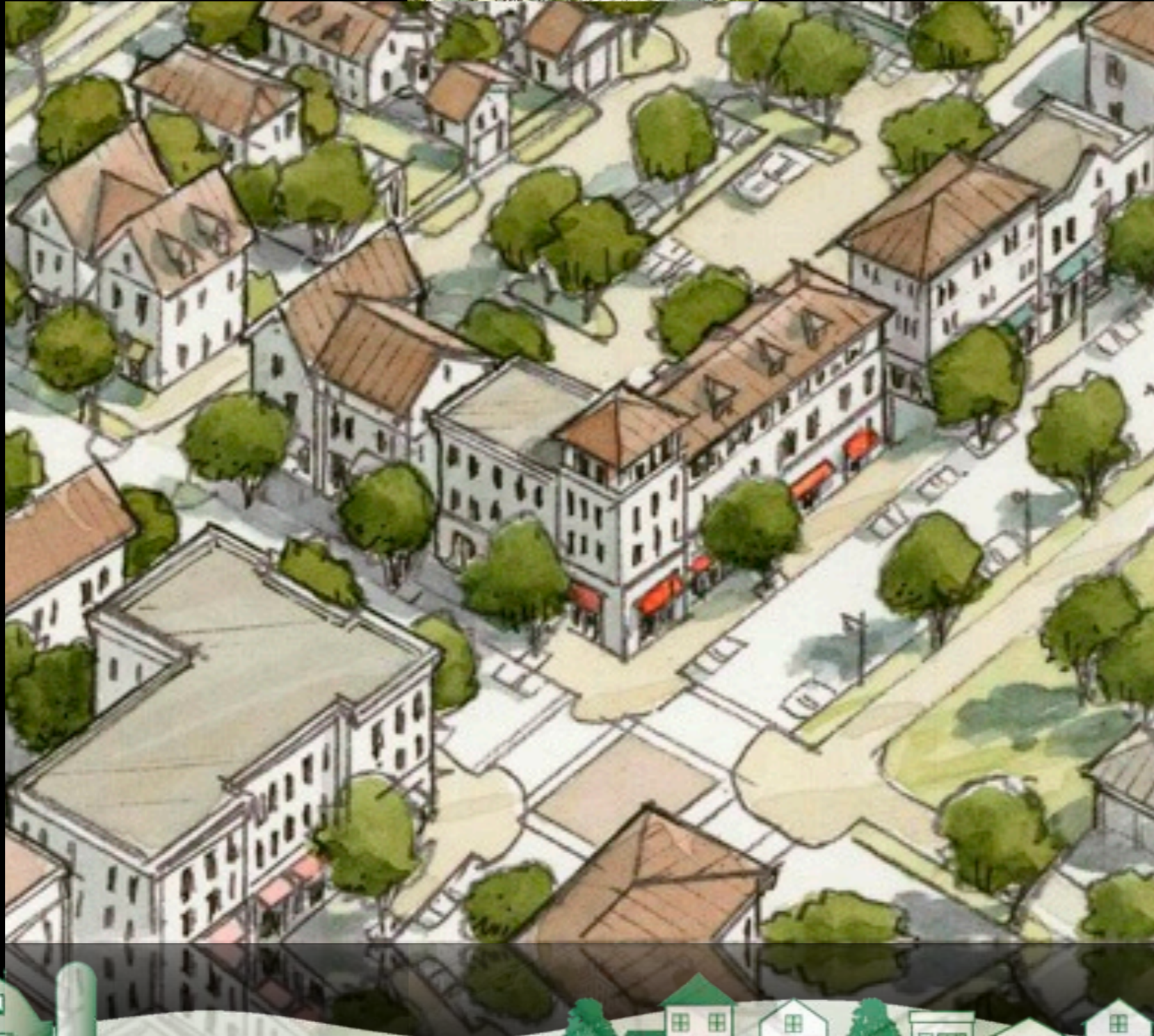
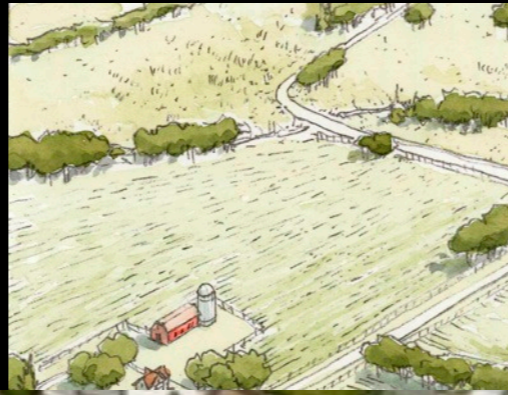











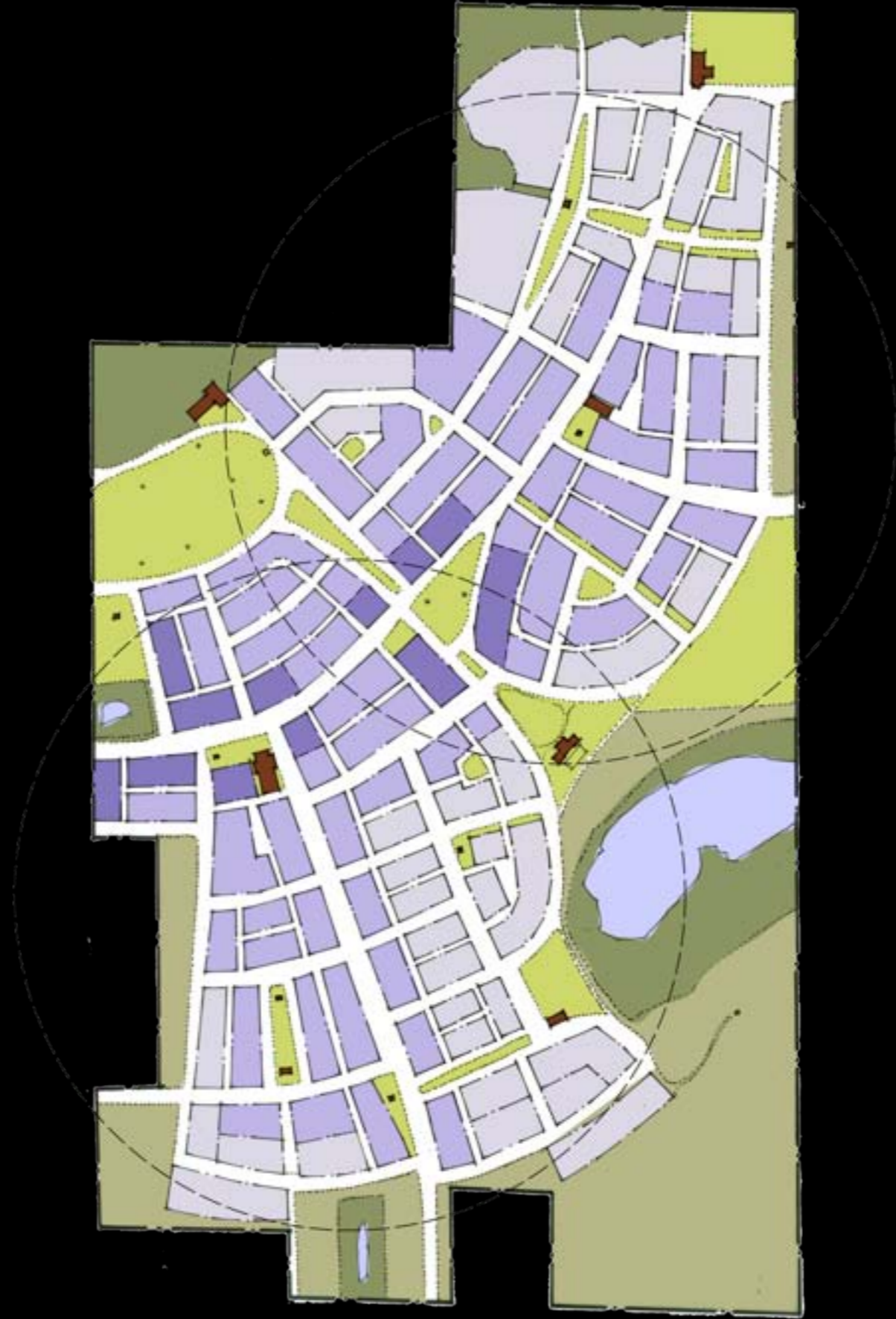





CHRISTOPHER 10
CHRISTOPHER 10





CAPSTONE '10















Comment Draft End of April



www.fitchburgzoning.com

